

WEINHEIM

Parks and Gardens



- Botanical Garden Hermannshof**
- Castle Palace Park**
- Exotic Forest**
- Town Garden**
- Public Garden**
- Old Cemetary**
- Rose Garden**

Weinheim's Parks and Gardens



Contents

TownCentreMap.....	4-5
Botanical Garden.....	6-9
Castle Palace Park	10-13
ExoticForest.....	14-17
Town Garden.....	18
Public Garden.....	18
Old Cemetery.....	19
Rose Garden.....	19
Gateway to the Odenwald....	20-21
Geopark-Trail	
"Stones, Gorges and Tales" ..	22-23

With the green slopes

...of the Odenwald forming a backdrop, and the Upper Rhine Valley stretching out before it basking in the sun, the picture-postcard town of Weinheim stands glorious along the Bergstrasse, touched by one of the earliest springs in Germany. Here where almond blossom, cherry tree, magnolia and forsythia buds open at the beginning of March; where figs and apricots ripen in the summer - you'll find the gardens of Weinheim, flowering in a mass of riotous colour.

Imprint

Editor:
Stadt Weinheim
Amt für Touristik, Kultur und Öffentlichkeitsarbeit
Stand 06/2022

Photos: T. Fischer, D. Flößer, G. Fuchs, R. Kern, F. Kopetzky, B. Nurish, R. Robra, Dr. C. Schmidt, Dr. U. Wilhelm, J. Wolf, M. Zimmermann





Discover a unique garden paradise - lush, green parks and gardens - neighbouring each other - not far from the former castles of the Barons of Berckheim and the old town centre.

Take a stroll in some of the most varied park and garden landscapes. Rare, non-native trees grow into ancient giants in the mild Weinheim climate. Such wonders of nature can be seen right at the entrance to the Schlosspark (Castle Palace Park). The biggest Lebanon Cedar tree in Germany stands here. A few steps further and you can immerse yourself in the aromas and scents of the homeopathic garden.

The neighbouring Exotenwald (Exotic Forest) offers a truly different experience. In just one afternoon you can walk through 18 different woodlands of the world, including a 60 metre high giant redwood forest.

The botanical garden Hermannshof provide a habitat for a variety

of plants and shrubs, from around the world, in beautifully landscaped beds. With its ancient woodland, the park is not a botanical garden in the true sense of the word, but rather a living textbook, demonstrating both plants and design ideas.

As a gateway to the Odenwald, Weinheim invites you to conquer the ruins of the Windeck and Wachenburg castles along well-marked trails. Or take a walk along the blossom-lined Bergstrasse beneath the castles perched high on the hills.

And don't miss a walk through the historic old town centre with its tanners' quarter. The Weinheim market square is one of the most beautiful places along the Bergstrasse. The rows of old houses and the numerous street cafés and restaurants under the Japanese Pagoda trees lend a truly romantic touch to the scene. Even on warm days in October it's still possible to sit outside and enjoy a glass of the local wine.

Weinheim Town Centre Map





Places of Interest

- ① Castle Palace Park
- ② Exotic Forest
- ③ Botanical Garden Hermannshof
- ④ Tanners' Quarter
- ⑤ Museum
- ⑥ Windeck Castle
- ⑦ Wachenburg Castle
- ⑧ Old Cemetery
- ⑨ Bürgerpark
- ⑩ Public Garden
- ⑪ Town Garden
- ⑫ Rose Garden

i Stadt Weinheim
Tourist-Information

- Tourismus Service
Bergstrasse e.V.
- Info Centre of the Unesco
Geo-Nature Parks
Bergstrasse-Odenwald

Marktplatz 1
Phone: +49 6201 / 82 610
Fax: +49 6201 / 82 619
tourismus@weinheim.de

Opening Times:
Mon, Tue, Thu, Fri 10 am - 5 pm
Wed + Sat 10 am - 2 pm
Sun (March-Oct.) 11 am - 3 pm

Hermannshof Botanical Garden

Research and Educational Establishment

The botanical garden Hermannshof in Weinheim carry out research into the use of herbaceous perennials in accordance with ecological and aesthetic aspects. The garden have been open to the public free of charge since 1983 and is maintained by the Freudenberg Group and the Town of Weinheim.

Entry

Private Botanical Garden, open to the public, free of charge.

Public tours

free from April - October,
Dates and program on request
www.sichtungsgarten-hermannshof.de



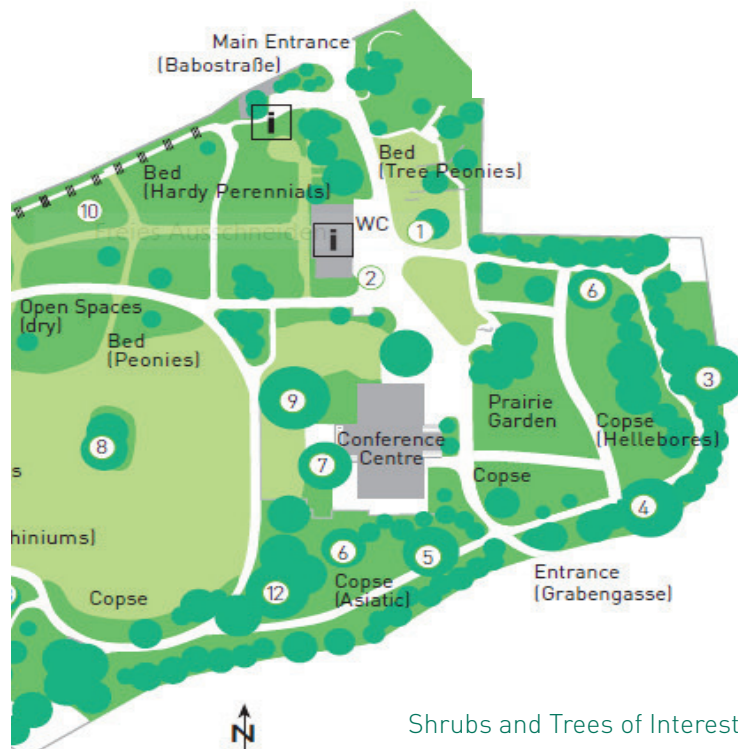

Shrubs and Trees of Interest

Opening Times

Summer: daily

March and October:

10 am - 6 pm

April to September:

10 am - 7 pm

Winter: Monday to Friday

10 am - 4 pm

(closed on bank holidays)

Closed from 24 December

to 6 January.

- ① Common Myrtle (130 years old)
- ② Kiwi (50 years old)
- ③ Oriental Plane (240 years old)
- ④ Hybrid Plane (240 years old)
- ⑤ Ginkgo (120 years old)
- ⑥ Dawn Redwood (60 years old)
- ⑦ Yulan Magnolia (120 years old)
- ⑧ Magnolia Soulangiana (120 years old)
- ⑨ Giant Redwood (120 years old)
- ⑩ Wisteria (85 years old)
- ⑪ Pocket Handkerchief Tree (50 years old)
- ⑫ Atlas Cedars (110 years old)
- ⑬ Evergreen Oak (90 years old)

Hermannshof Botanical Garden

Concept

Hermannshof carries out scientific and experimental work into the development of and the use of plants. In this, it follows three main aims: The investigation of the relationship between plants, in competition with each other, under varying conditions such as rate of growth and location.

Plant combinations which are pleasing to the eye. Both harmony and contrast are important here in terms of shape and colour.

The establishment of plants that stay attractive over a longer period of time, even with reduced care and attention.

Hermannshof displays its plants in such a way as to enable them to thrive in very natural settings.

Herbaceous perennials are displayed in 7 different areas, representing the most frequent locations for these plants:

copse, the edge of the copse, open spaces, rocky areas, the water bank, water and formal beds.

In this way you can discover over 2,500 different types of perennials. The garden is also characterized by old and often very rare trees and bushes. To those who love gardening, as well as to specialists, Hermannshof will give a lot of new ideas for creative but workable garden designs.



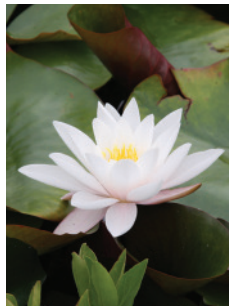

Schlosspark Weinheim Castle Palace Park

Weinheim's Castle Palace Park

...is one of the most-frequently visited parks along the Bergstrasse. The Castle Palace Park can be found next to the Castle Palace and is just a short distance away from the market square and the historic old town. The Castle Palace Park, landscaped in an English garden style, is for some a place of peace and relaxation and for others an island of exotic beauty with rare and ancient trees.

No matter which path you take, a new world opens right before your eyes. Whether a botanical adventure, for whiling away the time, for relaxation or as an attractive starting-point for your journey into the Exotic Forest, Hermannshof, the old town centre, to the castles ...

And there is something for children too - the newly-designed playgrounds are great fun - right at the heart of nature.

History

The origin of the Castle Palace Park can be traced back to 1700 with the formation of 2 baroque gardens - before probably Ludwig von Skell, Director of the Prince Elector's gardens, turned the Castle Palace Park into an English garden. The park as we know it came into existence in the 19th century, designed by the Countess Auguste von Waldner-Freundstein





and later Baron Christian von Berckheim, to whom we owe the richness in the variety of the trees.

The mausoleum of the von Berckheim family was built between 1908 and 1913 in the south-eastern corner of the Castle Palace Park.

The ownership of the castle palace and the park were transferred to the Town of Weinheim in 1938. Today the castle houses are the Town Hall. The park was opened to the public on 2 May 1939 with an official ceremony.

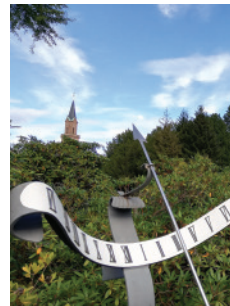

Schlosspark Weinheim Castle Palace Park

Highlights are:

- The oldest cedar tree in Germany in the small Castle Palace Park
- The homeopathic garden in the north-east corner of the park near the defence tower known as the „Blauer Hut“
- The Castle Palace Park pond with its fountains
- The circular path in the large Castle Palace Park with its superb view of the Odenwald, and Weinheim's castles
- The aviary with its exotic bird species
- Historic and modern sculptures

Picture Weinheim's Castle Palace Park - and you'll see large rhododendrons, yew, holly, box, fir trees, spruce, sweet chestnuts and pine trees.



But the Park is also well-known for its extensive lawns that are typical of a traditional English garden. It's not only nature and gardens that you'll discover here - there is also a programme of cultural events that takes place in and around the Park during the summer months - „Kultur im Sommer“, Weinheim fair, and concerts given by the Town's orchestra.

Trees and Tree Groupings of Particular Interest

- ① Lebanon Cedar (Germany's oldest)
- ② Metrosideros
- ③ Poncirus trifoliata
- ④ Japanese Pagoda
- ⑤ Gingko
- ⑥ Sassafras
- ⑦ Sweet gum
- ⑧ Kentucky coffeetree
- ⑨ Quercus robur
- ⑩ Atlas Cedar
- ⑪ Metasequoia
- ⑫ Mulberry
- ⑬ Coast Redwood

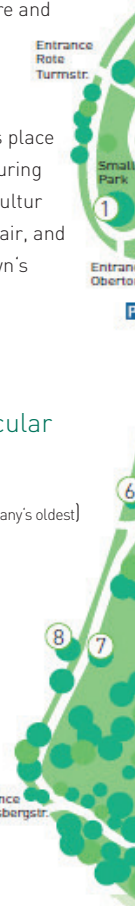



Tours

The Castle and Surroundings - Guided Tour
Info: Stadt Weinheim,
Tourist Information
Phone: +49 6201 82610



Exotenwald Weinheim

Exotic Forest

A Forest of Distant Lands, Peace and Relaxation

The Exotic Forest is a place to relax and unwind, close to the town centre with its bustling streets. Here a series of well sign-posted circular paths lead you through the forest where, since 1872, it has been possible to admire this imposing collection of magnificent, non-native, deciduous and coniferous trees. The cultivation of the forest serves not only to present a wide variety of interesting trees and shrubs, but also the observation and documentation of the growth-rate of the trees under Weinheim conditions.

Today there are around 170 different types of trees and bushes in the Exotic Forest. Each year three to five new species are added.

What is remarkable about the Forest is that it is a cultivated forest with a large number of trees and not individual trees as planted in a park.

The Forest itself is divided into the 18 woodland regions of the world whose trees are able to flourish in Weinheim. Trees from all of these 18 regions are represented today in the Exotic Forest.

At over 55 metres tall, the Giant Redwoods (*Sequoiadendron giganteum*) with their huge red-rimmed tree-trunks, are the tallest trees in the Forest. Originally from western North America, these trees were already 150 years old in 2022. They are among the tallest trees in Europe.





Entry

The Forest is the property of the State of Baden-Wuerttemberg and is open to the public. Entry to the Forest is free of charge. At each of the entrance points to the Forest, there are information boards showing three circular routes of varying length. Each circular route is signposted throughout the Forest.

There are also information boards giving information about a number of the trees in the Forest.

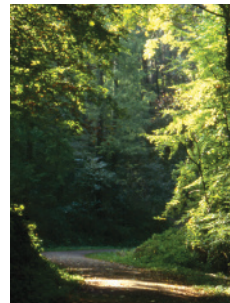
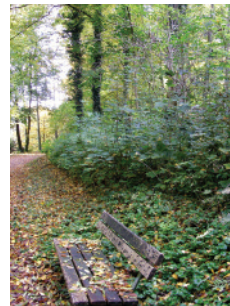

Exotenwald Weinheim Exotic Forest

History

The Exotic Forest was established by Christian, Baron von Berckheim in 1872. First of all he planted a large number of valuable trees along the paths and avenues.

Between the avenues he established a tree population with interesting, non-native trees, which mainly originated from North America, Asia Minor, North Africa and the Mediterranean.

Whilst a large proportion of the trees lining the avenues were lost at an early stage, the woodland trees grew into impressive and extremely interesting species.

A second planting phase began at the beginning of the 1930s following a 50-year slumber. This phase saw the introduction of Japanese and East-Asian tree species alongside the existing collection. The State of Baden-Wuerttemberg acquired the woodland in 1955 and started a new planting phase which has lasted until today.

The Exotic Forest has grown to a size of almost 60 hectares through the acquisition of new land. It is now not only well known for its collection of interesting, non-native trees and bushes, but is also a haven of peace and relaxation close to the town centre.



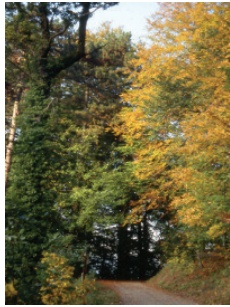

Particularly interesting tree collections

- 1 Giant Redwoods
- 2 Dawn Redwoods
- 3 Atlas Cedars
- 4 Chamaecyparis
- 5 Californian Incense Cedars
- 6 Thujas
- 7 Coast Redwoods
- 8 Araucaria

Radiant Autumn

- 1 Sugar Maples
- 2 Scarlet Oaks
- 3 Hickory
- 4 American Tulip Trees
- 5 Katsura
- 6 Wine Maples



Town Garden Public Garden Old Cemetery Rose Garde

Stadtgarten The Town Garden

... has undergone several changes over the years from vineyard to cemetery and is today a central park in the town. There are three important statues in the park. The first, built in 1999, is the memorial made of red Odenwald sandstone, to the victims of violence, war and persecution. The second is the Babo memorial, and lastly the Krausé-d-Avis grave. The historic well, known as the Geissenbrunnen, is also of interest.

Distinctive trees:

- American Northern Red Oak
- Horse Apple
- Horse Chestnut
- Sycamore Maple
- Crape Myrtle
- Mulberry
- Sassafras

Haganderpark The Public Garden

... formerly a private park, which was acquired by the Town of Weinheim in 1959. The gently-sloping park with its benches is a good alternative to the busy Bahnhofstrasse for those wishing to take a quiet stroll. Marvel at the avenue of ornamental cherry trees in full blossom in the spring. The two ginkgos will certainly be of interest to botanists - a female and male example stand next to each other, producing rare fruits in the autumn.

Botanical rarities:

- Golden Elm
- Ginkgo Biloba
- Cypress Oak
- Giant Redwood
- Ornamental Cherry Tree





Alter Friedhof The Old Cemetery

... is another impressive park in Weinheim. Enjoy a pleasant walk through the steeply inclined gardens with plants and trees that have stood here for years.

Picture the mighty 170 year-old plane trees. The Old Cemetery is a paradise for animals such as the edible dormouse and for birds such as the nuthatch, great tit and flycatcher. A family of badgers has lived here for many years. The Old Cemetery brings together an urban park, rural space and the protection of nature into one.

In the Cemetery, you can see a total of 93 graves, four of which are the graves of the freemen of Weinheim. The last burial at the Cemetery took place over 50 years ago. However, the old graves have been carefully restored in the last few years by a group of committed citizens of Weinheim, and those who look carefully at the grave stones will be taken back in time on a journey into Weinheim's past.

Rosenanlage Rose Garden

... a visit to the Rose Garden will be justly rewarded with a burst of blossom and colour from May right through to November. Here there are over 1,000 roses and 40 types of rose - all carefully tended by volunteers. A rose garden has been in existence on the site since 1950 - originally given to the people of Weinheim by the Earl of Berckheim.

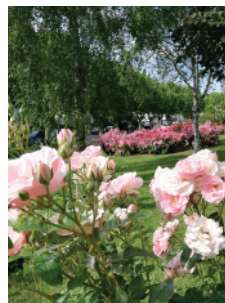

Weinheim - Tor zum Odenwald

Gateway to the Odenwald

Bergstrasse* and the foothills of the Odenwald

In addition to Weinheim's rural parks and paths, the town itself is an attractive starting point for hiking along the Bergstrasse and through the foothills of the Odenwald. There are a number of excellent rural walks, suggested by the Odenwald Club, which might tempt you to put your walking shoes on. The paths criss-cross the villages surrounding Weinheim - villages such as Luetzelsachsen, Hohensachsen, Oberflockenbach, Rippenweier, Ritschweier and Sulzbach.

Whether you just want to take a gentle stroll, a brisk walk or a mountain bike tour, there's something for everyone and plenty of inviting restaurants and pubs to keep you going along the way.

The Duerreplatz in Weinheim, an area at the northern end of the pedestrian zone, serves as a good starting point for walking. The Duerreplatz can be easily reached by car or public transport (bus station Duerreplatz)

*[Holiday route from Darmstadt to Heidelberg.]

5 suggestions for walking starting at the Duerreplatz

■ Starting point of the „Burgensteig“ (Castle Trail) is the open air pool (Gorxheimer Talstr. 40). If you are coming from Weinheim city, and you are looking to the open air pool, you could turn left (direction Darmstadt) or right (direction Heidelberg) to follow the trail. It leads either to the Wachenburg castle or way south through woodlands, vineyards above the village of Hohensachsen, with superb views into the Rhine Valley or Odenwald mountains.



(Burgensteig / Castle Trail ).

■ First the route takes you through the old town of Weinheim, the Castle Palace Park and the Exotic Forest. It then leads you through deciduous woodland via a plateau known as the „Kalter Herrgott“ where a farmer was said to have been struck by lightning, on to a village called Oberflockenbach and further to Weinheim's highest hill, the Eichelberg, 525 metres high (Route: .

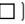

Literature

■ This route takes you via Weinheim's castles, the Windeck and the Wachenburg, through beech woods to a village called Buchklingen (Route: )

■ This route heading north may remind you of the Mediterranean. First it takes you through Weinheim, on through gardens and vineyards to a village called Sulzbach. By continuing along the trail through villages such as Hemsbach, Laudenbach and Heppenheim, you'll come across some superb views. You can access either the Blütenweg (the Blossom Trail ) or the Burgensteig (the Castle Trail ) from this route, which come together at intervals along the way.

■ One final suggestion takes you, first of all, through Weinheim, then up through orchards to a shelter called „Vogesenschau“ from where you'll have an impressive view of the Vosges mountains. Then over the hills of the Hirschkopf and Saukopf, through woods and forests with superb views and on to the Waldner Tower and the Juhöhe (one of the highest hills in the Odenwald with views over the Rhine valley into the distance)

(Route: )

Recommended further reading and maps are available in Weinheim's bookshops:

■ Topographic and trail map „Hessischer Odenwald Süd“ published by Meki Landkarten ISBN 978-3-947593-02-6

■ Topographic and trail map „Entlang der Bergstrasse von Darmstadt bis Heidelberg“ published by Meki Landkarten ISBN 978-3-931273-70-5



Geopark-Pfad „Steine, Schluchten und Sagen“

Geopark-Trail “Stones, Gorges and Tales”

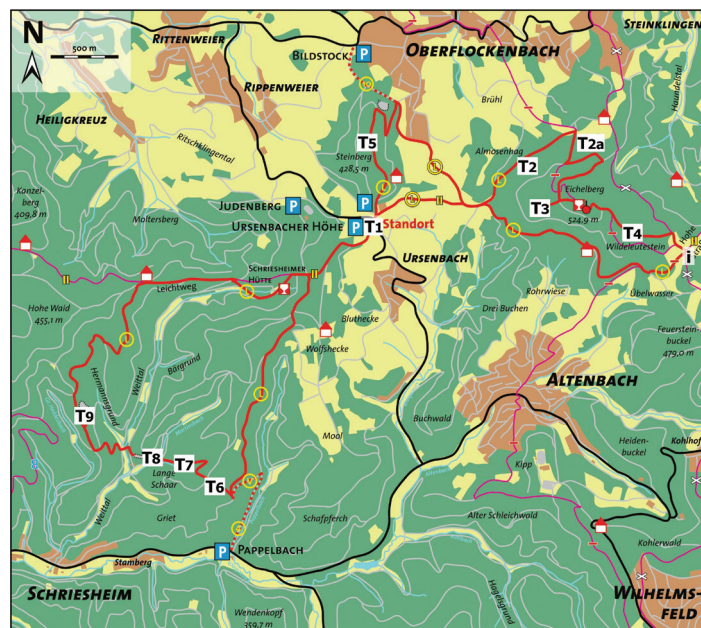

Information Points:

- | | |
|---|---|
| T1 Stones, Gorges and Tales | T6 Upper Griet - pits, trenches and excavation holes |
| T2 Glaciers in the Odenwald? - The formation of the „Bed of Rocks“ („Felsenmeer“) | T7 The „Lange Schar Drift“ and its layers |
| T2a Hard as Granite? - Granite weathering | T8 Spatschlucht - a spar gorge |
| T3 An area rich in minerals and stone - the quarrymen of Eichelberg and Steinberg | T9 Feldspar mining at Hermannsgrund |
| T4 The „wild people“ of Eichelberg - Tales and Truth | i Map of hiking trails in the foothills of the Odenwald |
| T5 The secret of Steinberg - A puzzle of geology and cultural history | |

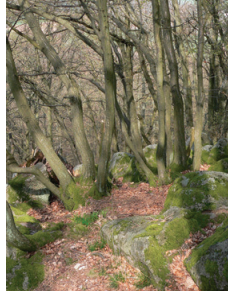

A variety of different rock and stone characterize the surroundings of Oberflockenbach near Weinheim and Ursenbach near Schriesheim. They are witnesses to the history of the Earth and have influenced the cultural lives of the people living here facilitating their commercial existence. The Geopark Trail takes you on a journey of 16 kilometres into this world of „Stones, Gorges and Tales“ and the information boards dotted along the way tell you some interesting details and stories about the life of the people living in the Odenwald.

The Geopark-Trail is divided into two: The Weinheim loop and the Schriesheim loop. The Weinheim loop gives you an insight into the geological characteristics of the areas at Steinberg and Eichelberg, such as glacial flow and granite mining at Oberflockenbach. It also gives you information about historical places of interest, and tales and legends, neither proven nor refuted, passed from one generation to the next.

The Schriesheim loop takes you over the „Upper Griet“ pits, the „Lange Schar“ drift, the „Spatschlucht“ gorge and „Her-mannsgrund“, where excavation holes and gorges have left their mark as evidence of former mineral mining, giving you a glimpse into the labour and lives of miners in the 19th and 20th centuries.

The landscape, geology and cultural history of the Geopark overlap and directly influence each other, lending a particular charm to this panoramic trail.

Further information:
www.geo-naturpark.de
www.weinheim.de





Stadt Weinheim
Amt für Touristik, Kultur und
Öffentlichkeitsarbeit
Tourist Information

Marktplatz 1
69469 Weinheim

Germany

Phone: +49 (0) 6201 / 82 610
Fax: +49 (0) 6201 / 82 619

www.weinheim.de
tourismus@weinheim.de

